

# The Learning Centre at United Way of Winnipeg



**United Way**  
Winnipeg

*The user-friendly technology, friendly staff, affordability and central location made the Learning Centre an ideal place to host our Strengthening Community Businesses Workshop Series. I will certainly host future workshops here.*

**Billy Granger**  
**Business Counsellor,**  
**Build a Business Program**  
**SEED Winnipeg**

Minutes from downtown at 580 Main Street, The Learning Centre is conveniently located in Winnipeg's charming and historic Exchange District.

Close to dozens of restaurants, markets and hotels, it's easily accessed by many of the city's major bus routes. The facility also boasts ample access to parking on many of the surrounding streets and paid lots.

This bright, modern venue is a perfect blend of accessibility, affordability and usability ensuring your meeting or training session will be a resounding success.

### **Social Innovation**

*The development, implementation and expansion of products, services processes and systems and behaviours to meet social needs.*

The Learning Centre at United Way of Winnipeg was created to foster social innovation.

While priority is given to organizations and individuals working to improve the well being of people and our community, the main floor meeting room is a resource available to everyone. And because all fees help support United Way's work in our community, it also benefits everyone.

**Learning  
Centre  
Features**



*It was one of the best meetings I have experienced! United Way set up the room in a circle which prompted our program leader, Larry Morrisette to give the group a teaching on the Smudging Ceremony and promoted a safe and honest meeting of the minds.*

**Debra DiUbaldo,  
Chair, Ogijiita Pimatiswin  
Kinamatwin (OPK)**

**THEATRE** 75 person capacity

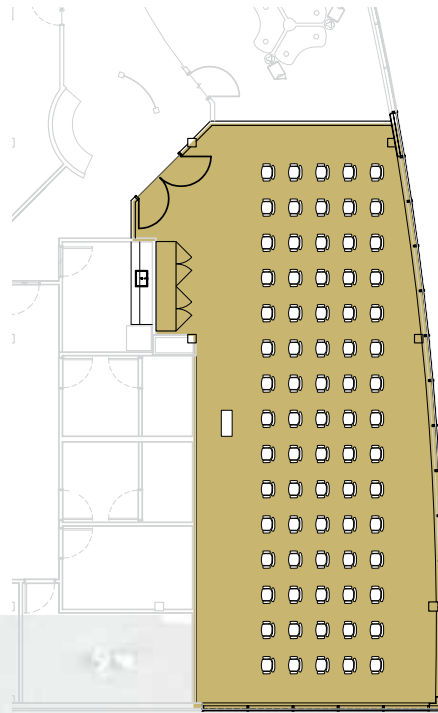

**CLASSROOM** 45 person capacity

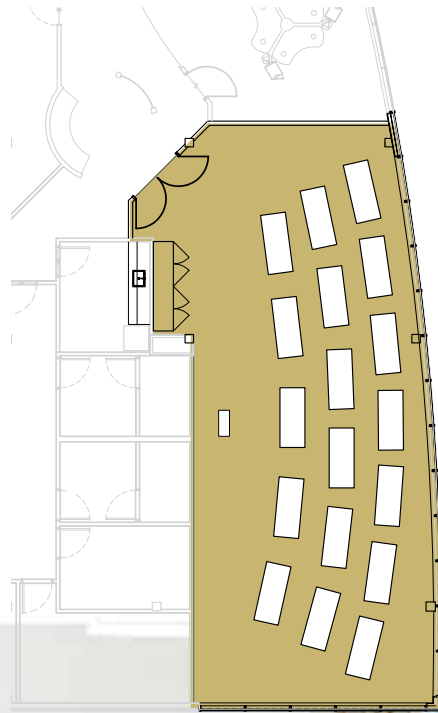

**BOARDROOM** 45 person capacity

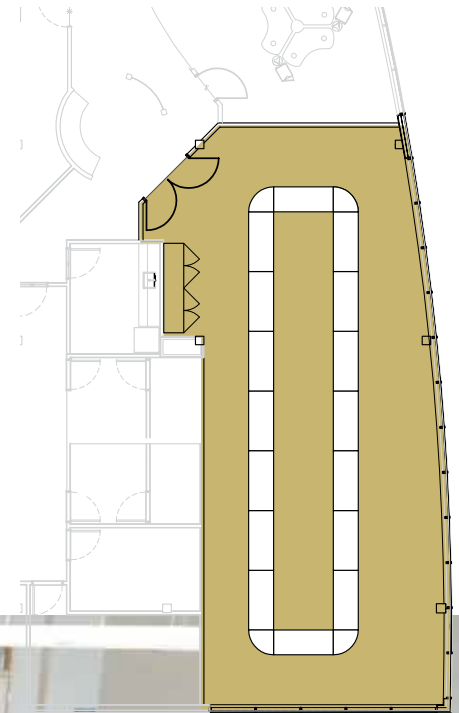

# Learning Centre

**SAMPLE  
CONFIGURATIONS**

*As a small program that trains and mentors new small scale farmers on growing food in a more sustainable way, we try to support local food and local farmers as much as we can when buying food for events.*

*Often venues have their own food services and we are unable to source the type of food we desire. United Way makes it easy not only to bring in locally produced food, but having the kitchen adjacent to the meeting room is fantastic.*

**Sheri Blaylock**  
Training & Resources Coordinator  
Manitoba Farm Mentorship

# Access

## ROOM ATTRIBUTES

### PHYSICAL SIZE

- 20' x 50' (approx. 1000 sq ft)

### CAPACITY

- Classroom configuration  
45 people
- Boardroom configuration  
45 people
- Theatre or standing room configuration  
75 people

## TECHNOLOGY

- Teleconferencing capabilities
- Overhead document camera
- Dual projectors & screens
- Annotation Tablet
- Surround sound
- Wi-Fi
- Onsite tech support included

## ADDITIONAL RESOURCES

- Wheelchair accessible
- Convenient parking
- Secure reception area
- Kitchenette
- Off street loading zone

## COSTS

- Non-profit organizations  
**\$40** half day / **\$80** full day
- Business and government  
**\$100** half day / **\$200** full day

*Note: prices subject to change without notice.  
On a budget? We can find an option that will work for you.*

## AVAILABILITY

The secure reception area is staffed from 7:00 am – 8:00 pm, Monday to Friday. Special arrangements can also be made for evenings and weekends.

Users will be responsible for additional costs associated with security outside of regular hours.

## CATERING

The meeting room is adjacent to a kitchen that contains a full size fridge, stove and dishwasher. Although not licensed for commercial food preparation, your caterer can use this kitchen as a staging area and avail themselves of the supplied cutlery and dinnerware.

## SOCIAL PURCHASING PORTAL

You may book any caterer you like, but the Social Purchasing Portal allows you to incorporate added social value in your selection of a service provider.

The Social Purchasing Portal highlights businesses and services that feature an added social benefit such as a commitment to hiring unemployed Winnipeggers who've experienced challenges accessing or returning to the workforce.

For a list of SPP caterers and other service providers, see [www.sppwinnipeg.org](http://www.sppwinnipeg.org)



## ACCESS

The building is wheelchair accessible and the main floor atrium provides easy access and high visibility for handi-transit pickups and drop offs.



## BUS

Several major routes service the building directly from Main and King Streets. For more information on downtown bus routes, see [www.WinnipegTransit.com](http://www.WinnipegTransit.com)



## PARKING

Plentiful street parking and paid parking lots provide ample space for large groups.

For a map of alternate parking, visit [www.UnitedWayWinnipeg.mb.ca/parking](http://www.UnitedWayWinnipeg.mb.ca/parking)





To make a booking,  
or for answers to additional questions,  
please call:

**Sherry McKay**

Community Host, or

**Yared Melketsadik**

Community Host

**United Way of Winnipeg**

580 Main Street

Winnipeg, Manitoba R3B 1C7

**P** 204-477-5360

**F** 204-453-6198

**W** [www.UnitedWayWinnipeg.mb.ca](http://www.UnitedWayWinnipeg.mb.ca)

**E** [uway@UnitedWayWinnipeg.mb.ca](mailto:uway@UnitedWayWinnipeg.mb.ca)



**United Way**  
Winnipeg

